

BASE, SINK, VENTED, AND TALL CABINETS



Pictured With Optional Recessed Handles

ABOUT

LAS manufactures multiple variations of standard base cabinets to accommodate countertops, sinks, plumbing, internal ventilation, and fume hoods. All cabinet doors are fastened with single-piece, recessed knuckle hinges and single piece polypropylene pulls. The internal, adjustable shelves are reversible, engineered for a one inch spill containment or a traditional flat surface. Standard base cabinets are available in sitting, standing and ADA compliant heights. The LAS tall cabinets range in height from five to seven feet high. Custom configurations and sizes are available and welcomed.

 9650 Newton Ave. S
Bloomington, MN 55431

 877.410.4910

 info@labairesystems.com

 www.labairesystems.com



LAS-500(L/R) Left/Right Hinged Full Door Base Cabinet With Shelf

Left or Right Hinged | (1) Adjustable Shelf with 1" Spill Containment Lip

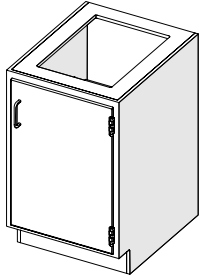

LAS-500R-182922

Sitting Height

| Model | Width | Height | Depth |
|------------------|-------|--------|-------|
| LAS-500L -182922 | 18" | 29" | 22" |
| LAS-500R-182922 | 18" | 29" | 22" |
| LAS-500L-242922 | 24" | 29" | 22" |
| LAS-500R-242922 | 24" | 29" | 22" |

Standing Height

| Model | Width | Height | Depth |
|------------------|-------|--------|-------|
| LAS-500L -183522 | 18" | 35" | 22" |
| LAS-500R-183522 | 18" | 35" | 22" |
| LAS-500L-243522 | 24" | 35" | 22" |
| LAS-500R-243522 | 24" | 35" | 22" |

LAS-510 Hinged Double Door Base Cabinet With Shelf

(1) Adjustable Shelf with 1" Spill Containment Lip

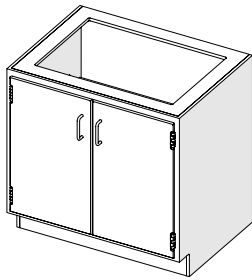

LAS-510-302922

Sitting Height

| Model | Width | Height | Depth |
|----------------|-------|--------|-------|
| LAS-510-302922 | 30" | 29" | 22" |
| LAS-510-362922 | 36" | 29" | 22" |
| LAS-510-422922 | 42" | 29" | 22" |
| LAS-510-482922 | 48" | 29" | 22" |

Standing Height

| Model | Width | Height | Depth |
|----------------|-------|--------|-------|
| LAS-510-303522 | 30" | 35" | 22" |
| LAS-510-363522 | 36" | 35" | 22" |
| LAS-510-423522 | 42" | 35" | 22" |
| LAS-510-483522 | 48" | 35" | 22" |

LAS-510S Hinged Double Door Sink Cabinet No Shelf

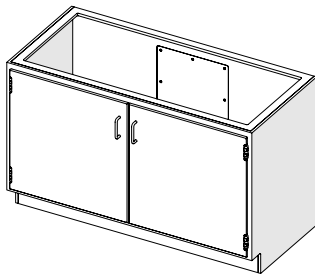

LAS-510S-482922

Sitting Height

| Model | Width | Height | Depth |
|-----------------|-------|--------|-------|
| LAS-510S-302922 | 30" | 29" | 22" |
| LAS-510S-362922 | 36" | 29" | 22" |
| LAS-510S-422922 | 42" | 29" | 22" |
| LAS-510S-482922 | 48" | 29" | 22" |

Standing Height

| Model | Width | Height | Depth |
|-----------------|-------|--------|-------|
| LAS-510S-303522 | 30" | 35" | 22" |
| LAS-510S-363522 | 36" | 35" | 22" |
| LAS-510S-423522 | 42" | 35" | 22" |
| LAS-510S-483522 | 48" | 35" | 22" |

LAS-510V Vented Acid Storage Double Door Base Cabinet With Shelf

(1) Adjustable Shelf with 1" Spill Containment Lip | (1) Polypro Vent 2" FPT Half Coupling

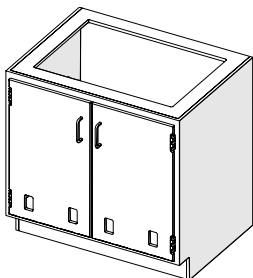

LAS-510V-302922

Sitting Height

| Model | Width | Height | Depth |
|-----------------|-------|--------|-------|
| LAS-510V-302922 | 30" | 29" | 22" |
| LAS-510V-362922 | 36" | 29" | 22" |
| LAS-510V-422922 | 42" | 29" | 22" |
| LAS-510V-482922 | 48" | 29" | 22" |

Standing Height

| Model | Width | Height | Depth |
|-----------------|-------|--------|-------|
| LAS-510V-303522 | 30" | 35" | 22" |
| LAS-510V-363522 | 36" | 35" | 22" |
| LAS-510V-423522 | 42" | 35" | 22" |
| LAS-510V-483522 | 48" | 35" | 22" |

LAS-511S ADA Open Sink Cabinet With Angle Board

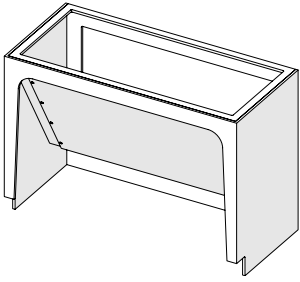

LAS-511S-483322

(1) Removable Angle Board

| Model | Width | Height | Depth |
|-----------------|-------|--------|-------|
| LAS-511S-303322 | 30" | 33" | 22" |
| LAS-511S-363322 | 36" | 33" | 22" |
| LAS-511S-423322 | 42" | 33" | 22" |
| LAS-511S-483322 | 48" | 33" | 22" |

LAS-500(L/R) Left/Right Solid Single Door 5ft. Tall Cabinet

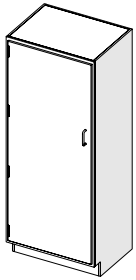

LAS-500L-246018

Left or Right Hinged
Shelves Have 1" Spill Containment Lip
(1) Fixed Shelf | (2) Adjustable Shelves

| Model | Width | Height | Depth |
|------------------|-------|--------|-------|
| LAS-500L -186018 | 18" | 60" | 18" |
| LAS-500R-186018 | 18" | 60" | 18" |
| LAS-500L-246018 | 24" | 60" | 18" |
| LAS-500R-246018 | 24" | 60" | 18" |

LAS-500(L/R) Left/Right Solid Single Door 7ft. Tall Cabinet

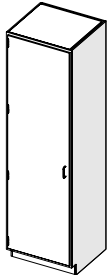

LAS-500L-248422

Left or Right Hinged
Shelves Have 1" Spill Containment Lip
(1) Fixed Shelf | (4) Adjustable Shelves

| Model | Width | Height | Depth |
|------------------|-------|--------|-------|
| LAS-500L -188422 | 18" | 84" | 22" |
| LAS-500R-188422 | 18" | 84" | 22" |
| LAS-500L-248422 | 24" | 84" | 22" |
| LAS-500R-248422 | 24" | 84" | 22" |

LAS-500(L/R)G Left/Right Framed Glazing Single Door 5ft. Tall Cabinet

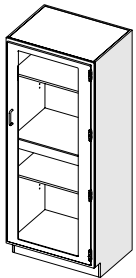

LAS-500RG-246018

Left or Right Hinged
Shelves Have 1" Spill Containment Lip
(1) Fixed Shelf | (2) Adjustable Shelves

| Model | Width | Height | Depth |
|-------------------|-------|--------|-------|
| LAS-500LG -186018 | 18" | 60" | 18" |
| LAS-500RG-186018 | 18" | 60" | 18" |
| LAS-500LG-246018 | 24" | 60" | 18" |
| LAS-500RG-246018 | 24" | 60" | 18" |



9650 Newton Ave. S
Bloomington, MN 55431



877.410.4910



info@labairesystems.com



www.labairesystems.com

LAS-500(L/R)G Left/Right Framed Glazing Single Door 7ft. Tall Cabinet

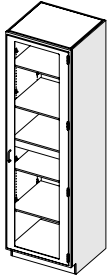

LAS-500RG-188422

Left or Right Hinged
Shelves Have 1" Spill Containment Lip
(1) Fixed Shelf | (4) Adjustable Shelves

| Model | Width | Height | Depth |
|-------------------|-------|--------|-------|
| LAS-500LG -188422 | 18" | 84" | 22" |
| LAS-500RG-188422 | 18" | 84" | 22" |
| LAS-500LG-248422 | 24" | 84" | 22" |
| LAS-500RG-248422 | 24" | 84" | 22" |

LAS-500(L/R)V Vented Left/Right Single Door 5ft. Tall Cabinet

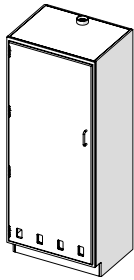

LAS-500LV-246018

Left or Right Hinged
Shelves Have 1" Spill Containment Lip
(1) Fixed Shelf | (2) Adjustable Shelves | (1) 2" FPT Vent Half Coupling

| Model | Width | Height | Depth |
|-------------------|-------|--------|-------|
| LAS-500LV -186018 | 18" | 60" | 18" |
| LAS-500RV-186018 | 18" | 60" | 18" |
| LAS-500LV-246018 | 24" | 60" | 18" |
| LAS-500RV-246018 | 24" | 60" | 18" |

LAS-500(L/R)V Vented Left/Right Single Door 7ft. Tall Cabinet

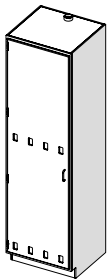

LAS-500LV-248422

Left or Right Hinged
Shelves Have 1" Spill Containment Lip
(1) Fixed Shelf | (4) Adjustable Shelves | (1) 2" FPT Vent Half Coupling

| Model | Width | Height | Depth |
|-------------------|-------|--------|-------|
| LAS-500LV -188422 | 18" | 84" | 22" |
| LAS-500RV-188422 | 18" | 84" | 22" |
| LAS-500LV-248422 | 24" | 84" | 22" |
| LAS-500RV-248422 | 24" | 84" | 22" |

LAS-510 Hinged Solid Double Door 5ft. Tall Cabinet

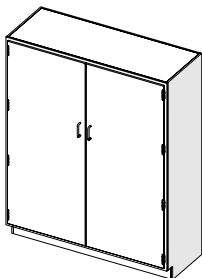

LAS-510-486018

Shelves Have 1" Spill Containment Lip | (1) Fixed Shelf | (2) Adjustable Shelves

| Model | Width | Height | Depth |
|----------------|-------|--------|-------|
| LAS-510-306018 | 30" | 60" | 18" |
| LAS-510-366018 | 36" | 60" | 18" |
| LAS-510-426018 | 42" | 60" | 18" |
| LAS-510-486018 | 48" | 60" | 18" |

LAS-510 Hinged Solid Double Door 7ft. Tall Cabinet

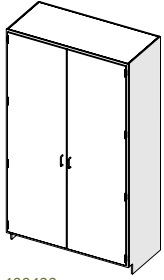

LAS-510-488422

Shelves Have 1" Spill Containment Lip | (1) Fixed Shelf | (4) Adjustable Shelves

| Model | Width | Height | Depth |
|----------------|-------|--------|-------|
| LAS-510-308422 | 30" | 84" | 22" |
| LAS-510-368422 | 36" | 84" | 22" |
| LAS-510-428422 | 42" | 84" | 22" |
| LAS-510-488422 | 48" | 84" | 22" |

LAS-510G Hinged Framed Glazing Double Door 5ft Cabinet

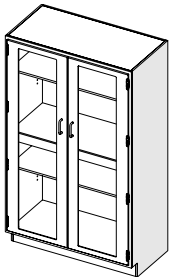

LAS-510-488418

Shelves Have 1" Spill Containment Lip | (1) Fixed Shelf | (2) Adjustable Shelves

| Model | Width | Height | Depth |
|-----------------|-------|--------|-------|
| LAS-510G-306018 | 30" | 60" | 18" |
| LAS-510G-366018 | 36" | 60" | 18" |
| LAS-510G-426018 | 42" | 60" | 18" |
| LAS-510G-486018 | 48" | 60" | 18" |

LAS-510G Hinged Framed Glazing Double Door 7ft. Cabinet

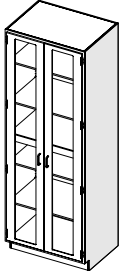

LAS-510G-308422

Shelves Have 1" Spill Containment Lip | (1) Fixed Shelf | (4) Adjustable Shelves

| Model | Width | Height | Depth |
|-----------------|-------|--------|-------|
| LAS-510G-308422 | 30" | 84" | 22" |
| LAS-510G-368422 | 36" | 84" | 22" |
| LAS-510G-428422 | 42" | 84" | 22" |
| LAS-510G-488422 | 48" | 84" | 22" |

LAS-510V Hinged Vented Double Door 5 ft. Tall Cabinet

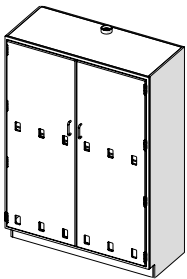

LAS-510V-426018

Shelves Have 1" Spill Containment Lip | (1) Fixed Shelf | (2) Adjustable Shelves

| Model | Width | Height | Depth |
|-----------------|-------|--------|-------|
| LAS-510V-306018 | 30" | 60" | 18" |
| LAS-510V-363018 | 36" | 60" | 18" |
| LAS-510V-426018 | 42" | 60" | 18" |
| LAS-510V-486018 | 48" | 60" | 18" |



9650 Newton Ave. S
Bloomington, MN 55431



877.410.4910



info@labairesystems.com



www.labairesystems.com

LAS-510V Hinged Vented Double Door 7 ft. Tall Cabinet

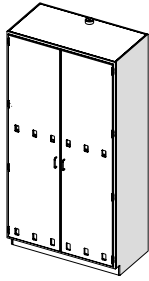

LAS-510V-428422

Shelves Have 1" Spill Containment Lip | (1) Fixed Shelf | (4) Adjustable Shelves

| Model | Width | Height | Depth |
|-----------------|-------|--------|-------|
| LAS-510V-308422 | 30" | 84" | 22" |
| LAS-510V-368422 | 36" | 84" | 22" |
| LAS-510V-428422 | 42" | 84" | 22" |
| LAS-510V-488422 | 48" | 84" | 22" |

LAS-510N Open Shelf Book Case Base Cabinet

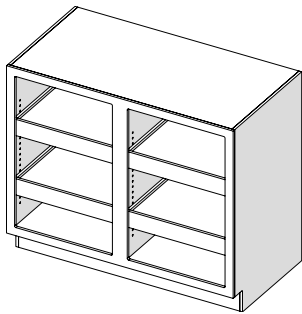

LAS-510N-423522

LAS-510N-18 & LAS-510N-24 Models: (2) Adjustable Shelves with 1" Spill Containment Lip
All Other Models: (4) Adjustable Shelves with 1" Spill Containment Lip

| Sitting Height | | | | Standing Height | | | |
|-----------------|-------|--------|-------|-----------------|-------|--------|-------|
| Model | Width | Height | Depth | Model | Width | Height | Depth |
| LAS-510N-182922 | 18" | 29" | 22" | LAS-510N-183522 | 18" | 35" | 22" |
| LAS-510N-242922 | 24" | 29" | 22" | LAS-510N-243522 | 24" | 35" | 22" |
| LAS-510N-302922 | 30" | 29" | 22" | LAS-510N-303522 | 30" | 35" | 22" |
| LAS-510N-362922 | 36" | 29" | 22" | LAS-510N-363522 | 36" | 35" | 22" |
| LAS-510N-422922 | 42" | 29" | 22" | LAS-510N-423522 | 42" | 35" | 22" |
| LAS-510N-482922 | 48" | 29" | 22" | LAS-510N-483522 | 48" | 35" | 22" |

LAS-510(L/R)B Hinged Solid Double Door Left/Right Blind Corner Cabinet

22" Wide Blind Corner Area. (1) Adjustable Shelf with 1" spill Containment Lip

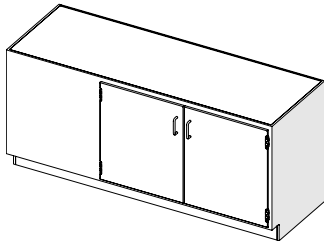

LAS-510LB-422922

| Sitting Height | | | | Standing Height | | | |
|------------------|-------|--------|-------|------------------|-------|--------|-------|
| Model | Width | Height | Depth | Model | Width | Height | Depth |
| LAS-510LB-302922 | 52" | 29" | 22" | LAS-510LB-303522 | 52" | 35" | 22" |
| LAS-510RB-302922 | 52" | 29" | 22" | LAS-510RB-303522 | 52" | 35" | 22" |
| LAS-510LB-362922 | 58" | 29" | 22" | LAS-510LB-363522 | 58" | 35" | 22" |
| LAS-510RB-362922 | 58" | 29" | 22" | LAS-510RB-363522 | 58" | 35" | 22" |
| LAS-510LB-422922 | 64" | 29" | 22" | LAS-510LB-423522 | 64" | 35" | 22" |
| LAS-510LB-422922 | 64" | 29" | 22" | LAS-510LB-423522 | 64" | 35" | 22" |
| LAS-510LB-482922 | 70" | 29" | 22" | LAS-510LB-483522 | 70" | 35" | 22" |
| LAS-510RB-482922 | 70" | 29" | 22" | LAS-510RB-483522 | 70" | 35" | 22" |

LAS-540(L/R) Hinged Solid Single Left or Right Door Corner Base Cabinet

(1) Adjustable Shelf with 1" Spill Containment Lip

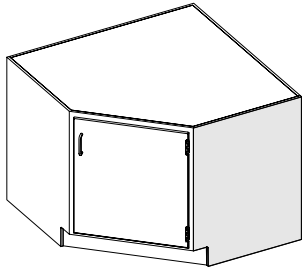

Sitting Height

| Model | Width | Height | Depth |
|-----------------|-------|--------|-------|
| LAS-540L-122922 | 12" | 29" | 22" |
| LAS-540R-122922 | 12" | 29" | 22" |
| LAS-540L-162922 | 16" | 29" | 22" |
| LAS-540R-162922 | 16" | 29" | 22" |

Standing Height

| Model | Width | Height | Depth |
|-----------------|-------|--------|-------|
| LAS-540L-123522 | 12" | 35" | 22" |
| LAS-540R-123522 | 12" | 35" | 22" |
| LAS-540L-163522 | 16" | 35" | 22" |
| LAS-540R-163522 | 16" | 35" | 22" |

LAS-540R-162922



9650 Newton Ave. S
Bloomington, MN 55431



877.410.4910



info@labairesystems.com



www.labairesystems.com